

ROHS

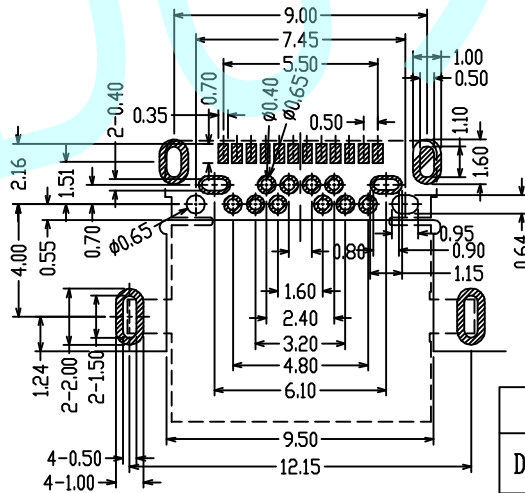
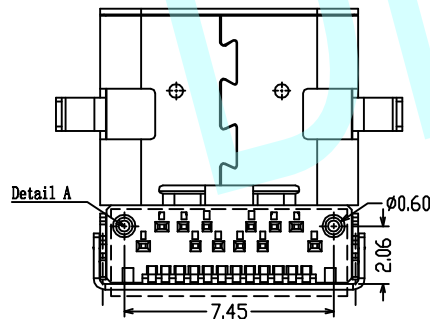
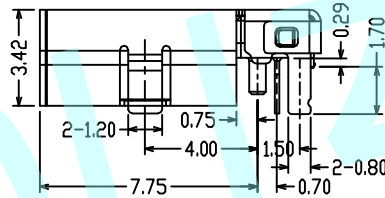
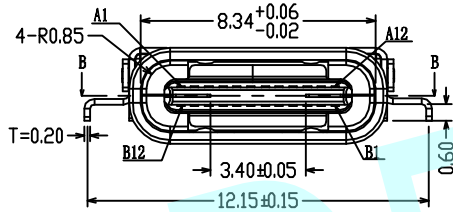
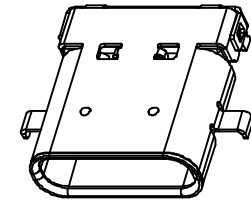
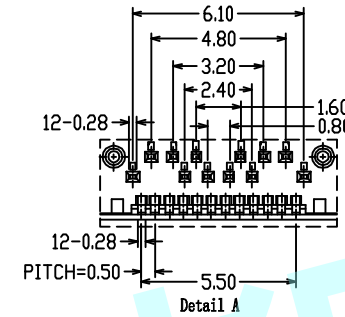
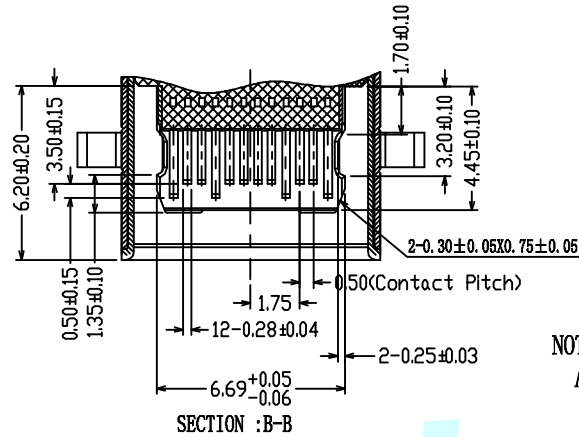
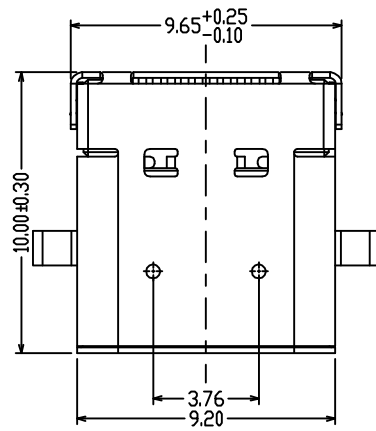

Recommended PCB Layout (Component Side)
Tolerance For PCB Layout Is ±0.05
Keep Out Area

NOTES:

- A. MATERIAL:
 1. Insulator :High Temperature Plastic UI 94 V-0
 2. Contact :Copper Alloy(T=0.15mm)
 3. Shell:Stainless Steel(T=0.20mm)
- B. ELECTRICAL CHARACTERISTICS:
 1. Contact Resistance :40mΩ Max For Initial
10mΩ Change After Test. Measure At 20mV, 100mA
 2. Contact Current Rating :5A For VBus PIN,
1.25A For Vconn PIN
 3. Dielectric Withstanding Voltage:100V AC R. M. S
 4. Insulation Resistance 100mΩ Min
 5. Operating Temperature :-40℃~85℃
- C. MECHANICAL CHARACTERISTICS:
 1. Mating Force:5~20N
 2. Unmated Force :8~20N After Test
 3. Durability :10,000 Cycles
- D. PLATING:
 1. Terminal Contact :(SEE TAB) Gold Plating All
Over 50U" Min Nickel And 80U" Min Tin ALL Over 50U"
Min Nickel On Solder Area.
 2. Shell :50U" Min .Nickel All OVER

APPROVALS		DATE	http://www.dongdudz.com		
DRAW:	ZRD	2017-12-6	TOLERANCE:	ANGLE:	
			30≥	±0.30	±2°
CHECKED:	***	***	10°30	±0.20	
APPOVALS:	***	***	5°10	±0.15	
			≤5	±0.10	
东都电子 DONGDU ELECTRONICS		MODEL:		USB CONNECTOR	
		PART NO:		TYPE: C-3.1-01M	
		UNIT :mm	SCALE:1:1		
		REV:	A	PAGE:1/1	