

**ROHS**

CCW ← → CW  
PUSH

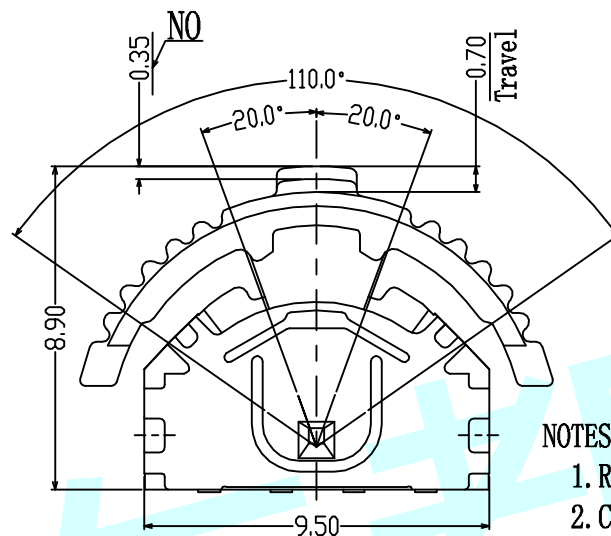
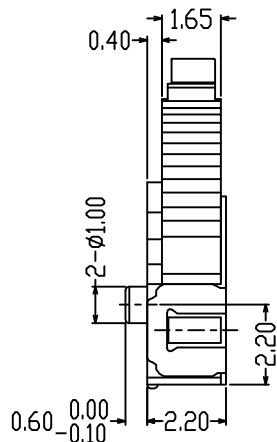
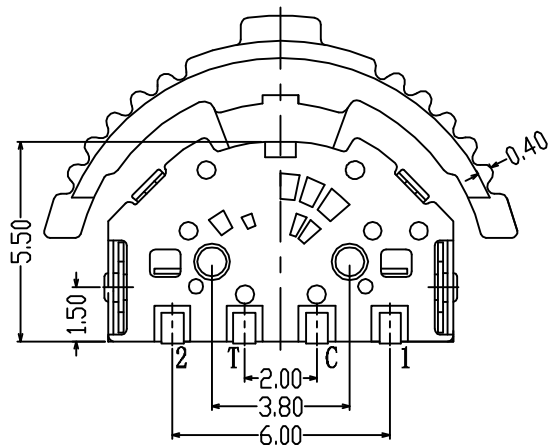

NOTES:

1. Rating: DC 5V 10mA
2. Contact resistance: 100mΩ MAX
3. Insulation resistance: 100MΩ MIN
4. Service life: 100,000 cycles
5. Operating temperature: -25 °C ~ +85 °C
6. Using humidity: ≤85% RH
7. Operating force:  
Lever portion: 70 ± 40gf  
Push Portion: 250 ± 40gf

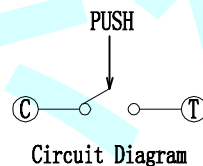

0° (■=NO)

TER	ANG	20°	15°	15°	20°
1		■			
2				■	■
3		■	■	■	■

CCW ← → CW

CODE TABLE

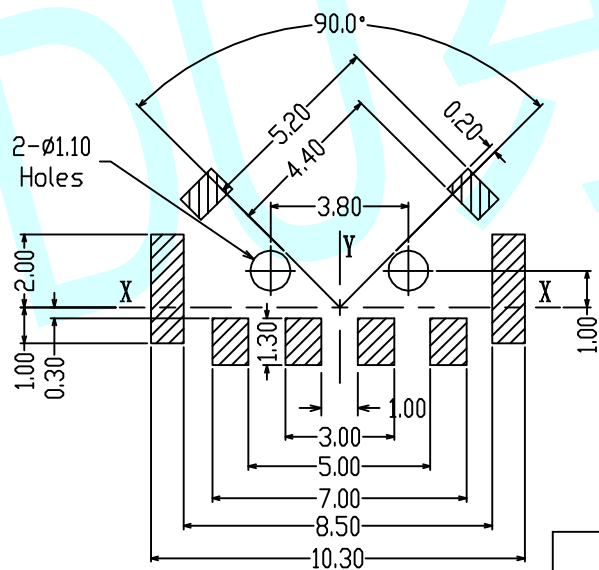

PCB Mounting  
Pattern Dimension

APPROVALS		DATE	http://www.dongdudz.com	
DRAW:	ZRD	2017-12-6	TOLERANCE:	ANGLE:
CHECKED:	***	****	30 ≥ ±0.30	±2°
APPOVALS:	***	****	10°30 ±0.20	
			5°10 ±0.15	
			≤5 ±0.10	

**东都电子**  
DONGDU ELECTRONICS

MODEL:	ROCKER SWITCH
PART NO:	DDU-1212
UNIT :mm	SCALE: 1:1
REV:	A

MODEL: ROCKER SWITCH  
PART NO: DDU-1212  
UNIT :mm SCALE: 1:1  
REV: A

PAGE: 1/1